

digipressto

 MADE IN EU design by KD

IT digipressto è straordinario: grazie a lui i vostri pannelli potranno diventare indicatori di direzione, banner pubblicitari, divisori di spazio o elementi decorativi per interni ed esterni. utilizzate a piacere la base in alluminio con pannelli di 30 mm: grazie alla sua speciale conformazione, pannelli di qualsiasi materiale rimangono stabili e dritti sulla base. digipressto si apre e si chiude grazie ad una vite a testa zigrinata che tiene uniti i 2 profili. i feltrini compresi nella confezione proteggono il pannello e rendono la base anti-scivolo e più stabile. nella versione in alluminio anodizzato color argento digipressto è disponibile già montato nei formati più comuni. il programma di accessori comprende tappi laterali in colore nero e 2 versioni laccate in nero rispettivamente di 100mm e 200mm (con tappi laterali neri).

DE eine tolle sache: mit ihrem panel wird digipressto zum hinweisschild, werbebanner, raumteiler oder dekorativem element im innen- und aussenbereich. kombinieren sie das aluminiumprofil mit paneelen der stärke von 30mm. unterschiedlichste materialien werden gleichmässig eingespannt. geöffnet und geschlossen wird digipressto mittels rändelschraube. integrierte gummilitzen schützen ihr panel und geben rutschfesten stand. in silber eloxierter ausführung sind die gängigsten längen vormontiert. im zubehör programm finden sie schwarze seitenabdeckkappen. ausserdem im programm: 100mm bzw. 200mm mit schwarzer pulverbeschichtung und abdeckkappen.

EN digipressto is really great: together with your panel digipressto becomes a signpost, an advertising banner, a partition wall or a decorative element in interior and exterior areas. combine the anodized aluminium profile with panel from 30mm. the special construction gives digipressto maximum flexibility: materials are shut in safely by digipressto. open and close the profile easily with the knurled head screw. integrated rubber laces protect your panel and act as anti-slip pads as well. the most standard lengths come already mounted. black side caps can be ordered as an accessory. furthermore we provide you with 100mm and 200mm lengths black powder coated and with side caps.

panel not included

1-4



profilo in alluminio anodizzato con protezione anti-scivolo, vite a testa zigrinata

klemmprofil aus eloxiertem aluminium, mit anti-rutsch schutz und rändelschraube

clamping profile made of anodized aluminium with anti-slip protection and knurled head screw

5



tappi laterali abs nero, set con 4 pz
seitenabdeckkappen abs schwarz, set mit 4 stück

lateral cover caps abs black, set with 4 pcs

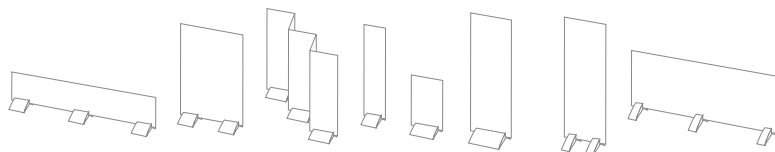



6 digipresto black 100mm

panel not included



6 digipresto 100mm laccato nero con tappi laterali
digipresto 100mm schwarz beschichtet mit seitenkappen schwarz

digipresto 100mm black coated with black side caps



7 digipresto 200mm laccato nero con tappi laterali

digipresto 200mm schwarz beschichtet mit seitenkappen schwarz

digipresto 200mm black coated with black side caps

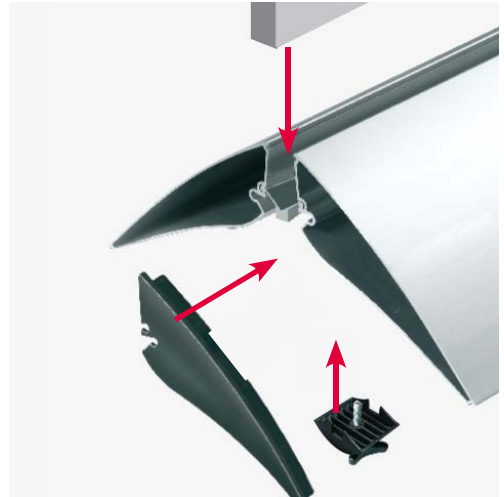

8 in zamac color argento per fissare pannelli a „sandwich“. cacciaviti a parte.

versilberter metalldruckguss für die sicherung von sandwich systemen. inbus-schlüssel bitte extra bestellen.

silver-plated metal die-cast for locking sandwich systems. order the required keys separately.

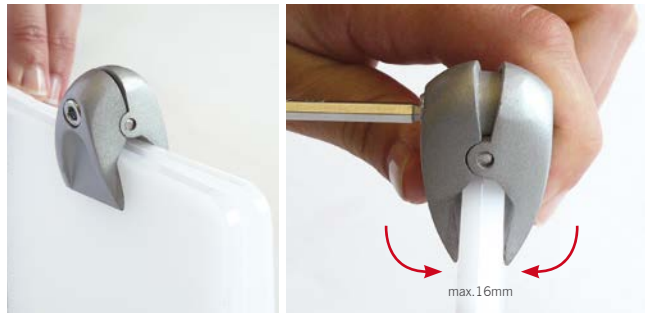
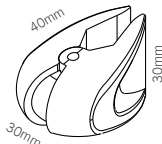

9

digipresto



1	PT235	digipresto silver 235mm, 1pc	
2	PT300	digipresto silver 300mm, 1pc	
3	PT400	digipresto silver 400mm, 1pc	
4	PT500	digipresto silver 500mm, 1pc	
5	PTAKSZ	cover caps black, 4pcs	
6	PT100SZ	digipresto black 100mm, 1pc	
7	PT200SZ	digipresto black 200mm, 1pc	
8	IX2BSWAR	ixbond sandwich connector, 1pc	
9	SOKEY4	t-handle hex key, 1pc	

information

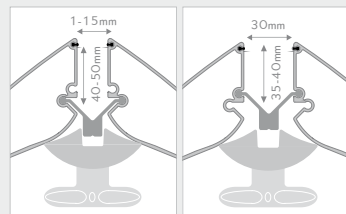

l'altezza massima del pannello varia a seconda del materiale utilizzato e del suo spessore. ogni applicazione deve essere verificata prima della installazione.

maximale paneel-höhe und -breite sind vom verwendeten plattenmaterial abhängig. jede anwendung ist daher individuell auf eignung zu prüfen.

maximum panel height and width depend on the used material. every application has to be approved individually if appropriate.